

1.3 **DRAWINGS**

.1 **Reference New Civil Drawings:**

- .1 The following new Civil Drawings, dated 07 October 2021, are attached and forming part of this Addendum:
- .1 Drawing C1-101 Existing Site Plan
 - .2 Drawing C1-102 New Site Plan
 - .3 Drawing C1-103 Details and Notes

.2 **Reference New Electrical Drawings:**

- .1 The following new Electrical Drawings, dated 20 October 2021, are attached and forming part of this Addendum:
- .1 Drawing E1-101 Electrical Site Plan, Legend & Details
 - .2 Drawing E1-102 Electrical Room Layout, Enlargement Plan & Fuel Management Riser
- .2 Contractor is to provide all labour, material and plant associated with the electrical work indicated in attached new Electrical Drawings E1-101 & E1-102 dated 20 October 2021, attached and forming part of this addendum. Coordinate work with the Owner and other Contractors on site.

END OF SECTION



- LEGEND**
- PROPERTY LINE
 - EXISTING TOP OF BANK
 - EXISTING EDGE OF ASPHALT
 - EXISTING BUILDING OUTLINE
 - EXISTING FENCE LINE
 - EXISTING UTILITY POLE
 - EXISTING FLASHING LIGHT
 - EXISTING GRADE ELEVATION

- SITE NOTES**
- SITE UTILITIES**
- A. ARRANGE TO LOCATE ALL UNDERGROUND AND ABOVEGROUND UTILITIES AND SERVICES PRIOR TO CONSTRUCTION. RECORD ALL AS-BUILT INFORMATION INCLUDING HORIZONTAL AND VERTICAL ALIGNMENT.
- TRAFFIC CONTROL**
- B. THE EXISTING FACILITY WILL BE OPERATIONAL DURING THIS PHASE OF THE CONSTRUCTION. ERECT SAFETY FENCING (ORANGE SNOW FENCING TYPE) COMPLETE WITH POSTS AROUND CONSTRUCTION SITES.
- C. PROVIDE BARRICADES & BARRIERS AS REQUIRED.
- D. PROVIDE SIGNS AND TRAFFIC CONTROL DEVICES AS REQUIRED BY REGULATIONS.
- EXISTING TANKS**
- E. RELOCATE DEF TANK, FUEL OIL TANK INCLUDING PRECAST CONCRETE BASE CONTAINMENT, USED OIL TANK AND ALL ASSOCIATED APPURTENANCES TO A LOCATION ON SITE AS IDENTIFIED BY THE OWNER. RECONNECT OIL TANK TO CONTROLS INSIDE THE BUILDING FOR A COMPLETELY OPERATIONAL SYSTEM.
- WATER WELL**
- F. DRILL A NEW DOMESTIC WATER WELL AT LOCATION AS INDICATED ON NEW SITE PLAN C102 AND AS SHOWN ON MECHANICAL DRAWINGS. TEST AND COMMISSION NEW WELL IN ACCORDANCE WITH PEI DOE STANDARDS. CONNECT NEW WELL TO BUILDING WATER SUPPLY. DISCONNECT EXISTING WELL AND DECOMMISSION IN CONFORMANCE WITH PROVINCIAL REGULATIONS.
- BUS PARKING LOT**
- G. CLEAR AND GRUB ENTIRE AREA OF THE NEW BUS PARKING LOT. ALLOW FOR 5m REMOVAL BEYOND THE OUTLINE OF THE PARKING LOT. REMOVE AND DISPOSE OF MATERIAL OFF SITE.
- H. ROUGH GRADE AND LEVEL SURFACE OF THE NEW PARKING LOT.
- ACCESS ROAD**
- I. CONSTRUCT ACCESS ROAD TO NEW PARKING LOT. REMOVE UNSUITABLE SOIL MATERIAL AND CONSTRUCT USING 300mm STRUCTURAL FILL AND 200mm CLASS 'A' GRAVEL.
- EMBANKMENT BEHIND WAREHOUSE**
- J. EXCAVATE AND REMOVE EXISTING EMBANKMENT NORTH-EAST OF THE EXISTING WAREHOUSE. ALLOW FOR A FLAT WORKING SURFACE OF 10m WIDE BEHIND THE EXISTING & NEW BUILDING.
- FRONT PARKING LOT**
- K. EXPAND THE SOUTH AREA OF THE EXISTING FRONT PARKING LOT TOWARDS THE ROAD DITCH. BACKFILL USING SELECT BORROW AND FINISH WITH 200mm CLASS A GRAVEL ALL COMPACTED TO 100% SPMD.

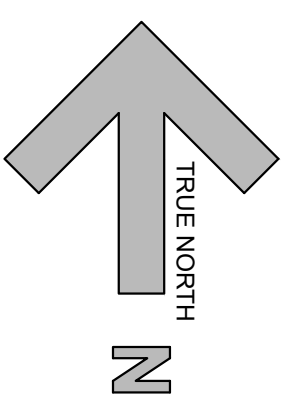

1 EXISTING SITE PLAN
Scale 1:500



Suite 201, 85 Fitzroy Street
Charlottetown, PEI, Canada, C1A 1R6
Phone (902) 368-2300
www.colesassociates.com

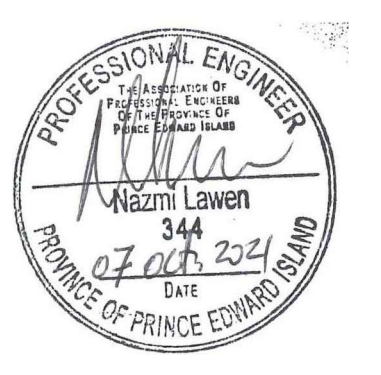

Client
PEI Department of
Transportation & Infrastructure

Project Title
Bridgetown Depot Building Addition

Sheet Title
Existing Site Plan

No.	Description	Date	Date:	Revision
0	Issued for Tender	2021-10-07	October 2021	
			Drn By: SPM, EIT	
			Chk By: NL, P.Eng	
			Project Number:	
			211120	
			Drawing Number:	
			C1-101	

LEGEND

	PROPERTY LINE
	EXISTING TOP OF BANK
	EXISTING EDGE OF ASPHALT
	EXISTING BUILDING OUTLINE
	EXISTING FENCE LINE
	EXISTING UTILITY POLE
	EXISTING FLASHING LIGHT
	EXISTING GRADE ELEVATION
	PROPOSED GRADE ELEVATION

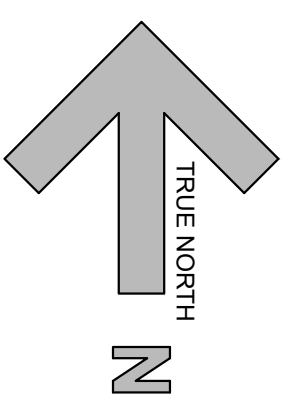

1 NEW SITE PLAN
 1:500

COLES
 Architecture + Engineering + Project Management

Suite 201, 85 Fitzroy Street
 Charlottetown, PEI, Canada, C1A 1R6
 Phone (902) 368-2300
 www.colesassociates.com



Client
**PEI Department of
 Transportation & Infrastructure**

Project Title
Bridgetown Depot Building Addition

Sheet Title
New Site Plan

No.	Description	Date	Date:	Revision
0	Issued for Tender	2021-10-07	October 2021	
			Drn By: SPM, EIT	
			Chk By: NL, P.Eng	
			Project Number:	
			211120	
			Drawing Number:	
			C1-102	

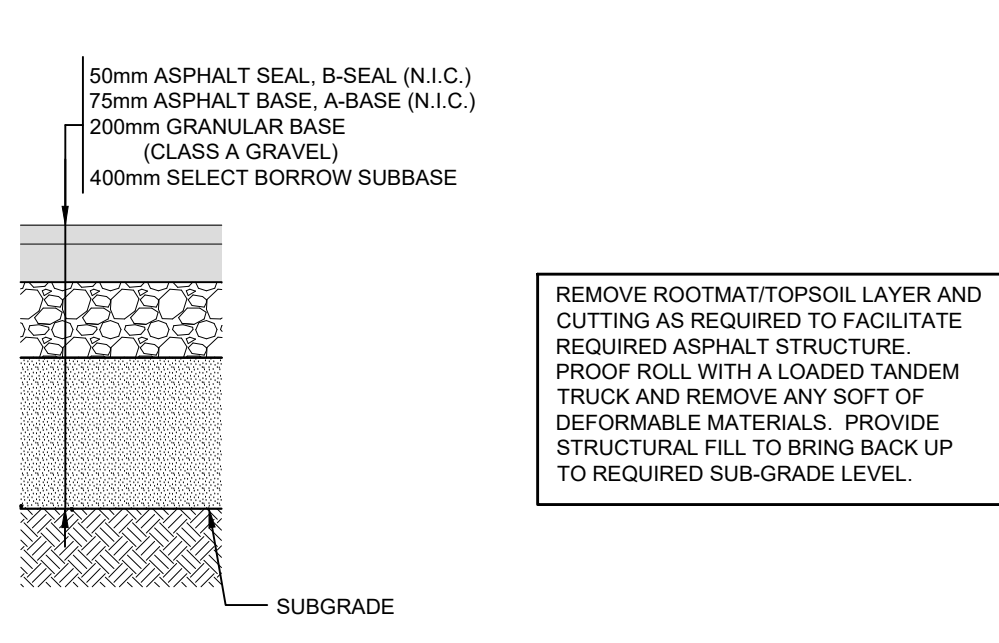

GRAVEL AREA

1 GRAVEL SCHEDULE
C100 C105 1:20

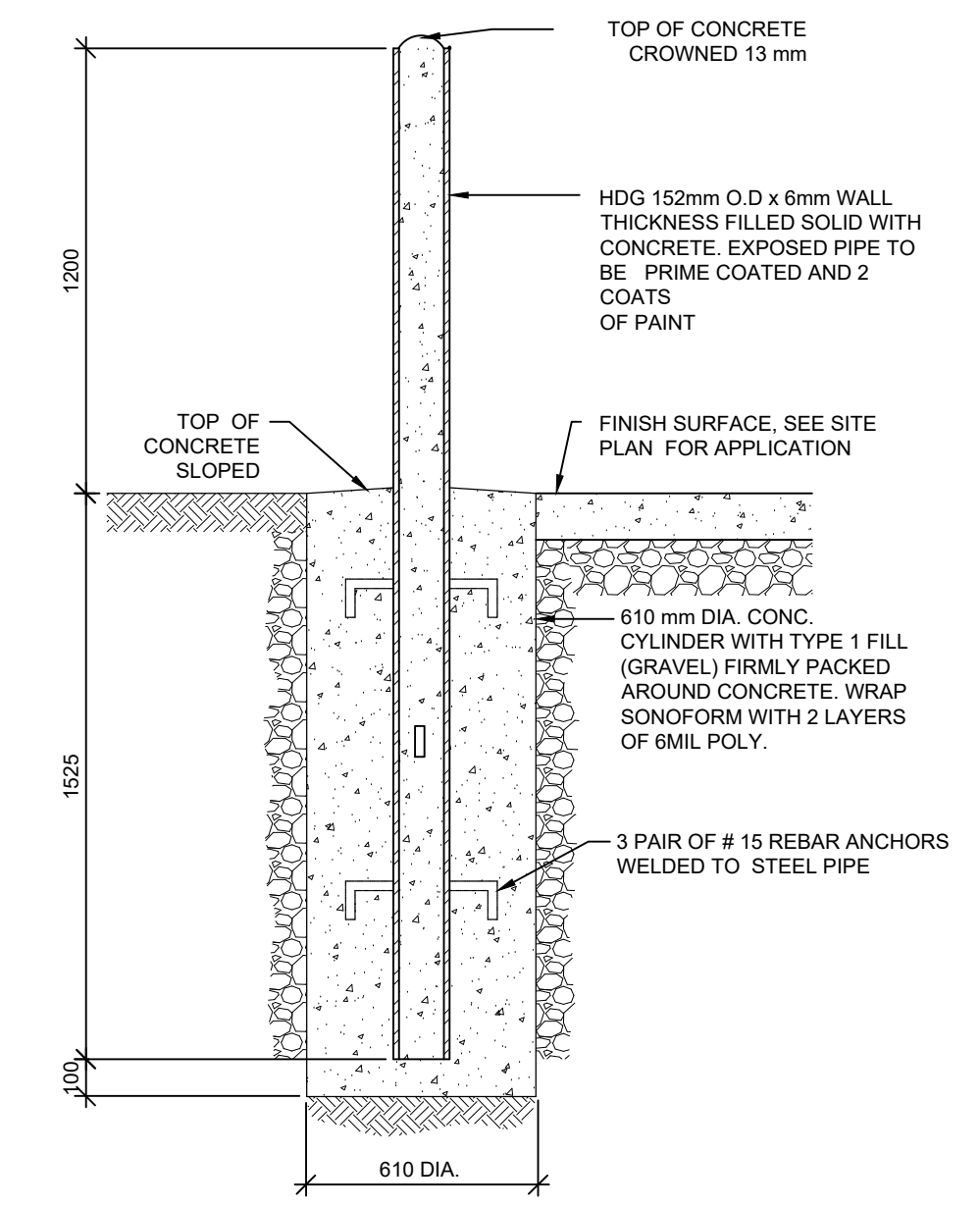

2 DETAIL: TYPICAL EXTERIOR BOLLARDS
C100 C105 1:20

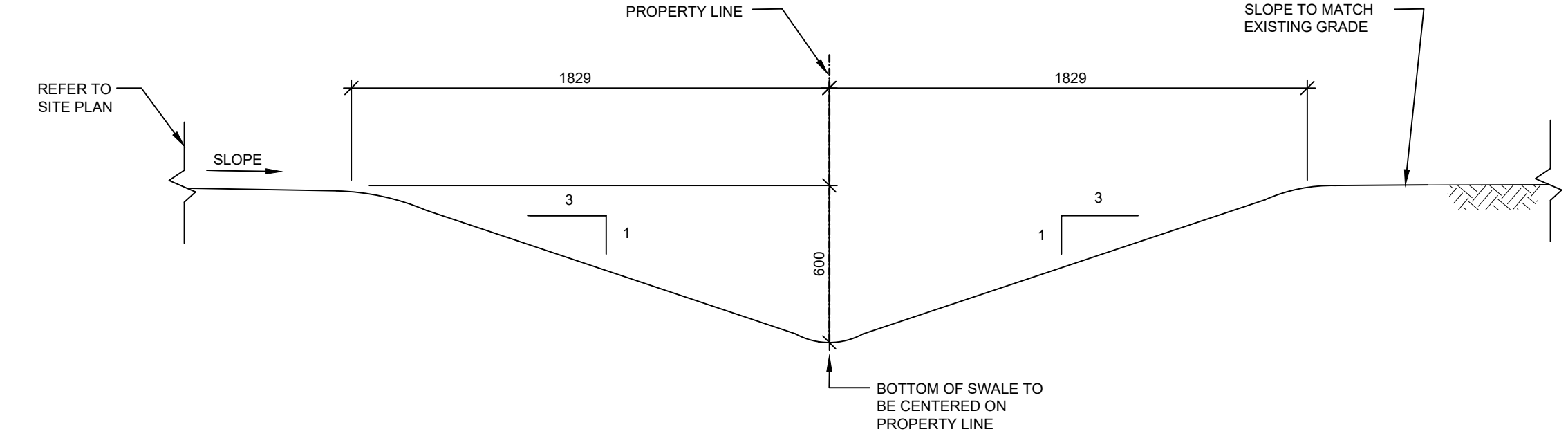

3 SECTION: DRAINAGE SWALE - WEST OF ROAD
C100 C105 1:20

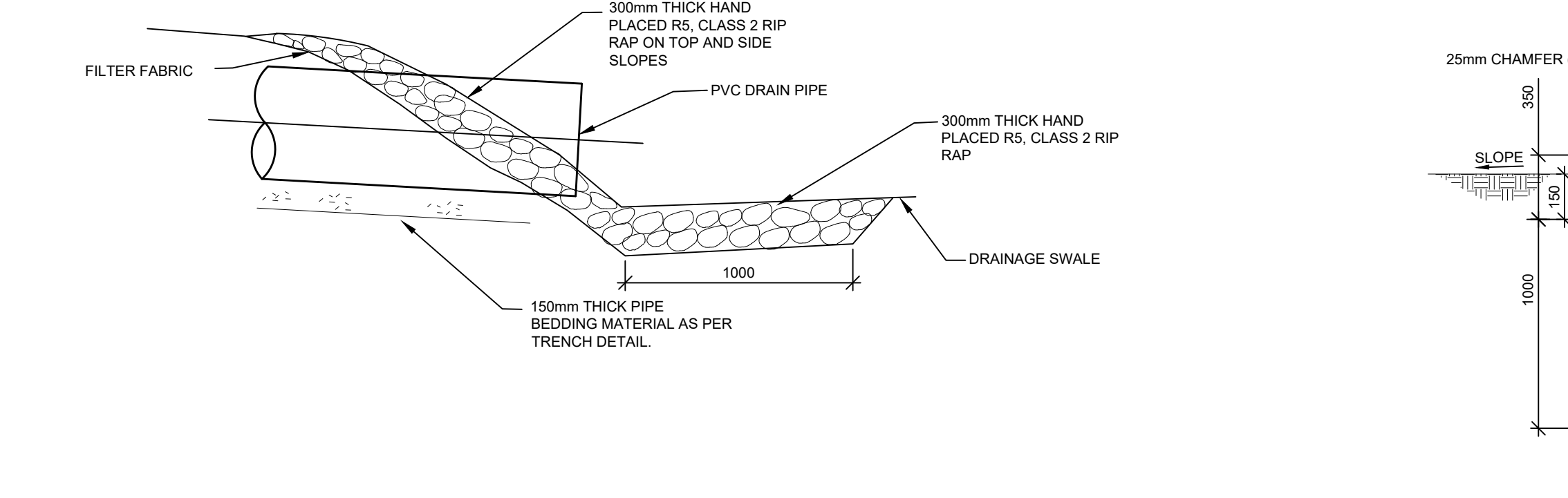

4 RIP RAP AT PIPE ENDS DETAIL
C100 C105 NTS

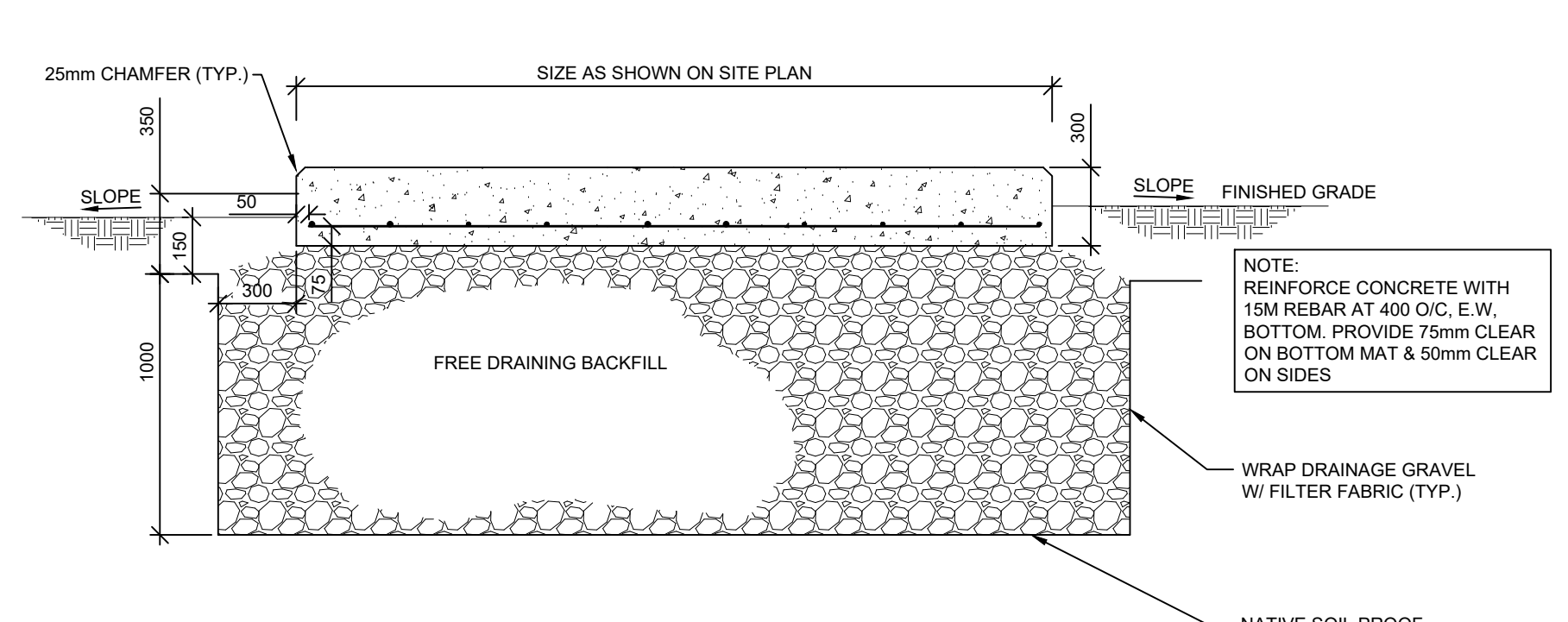

5 SECTION: TYPICAL CONCRETE PAD
C100 C105 NTS

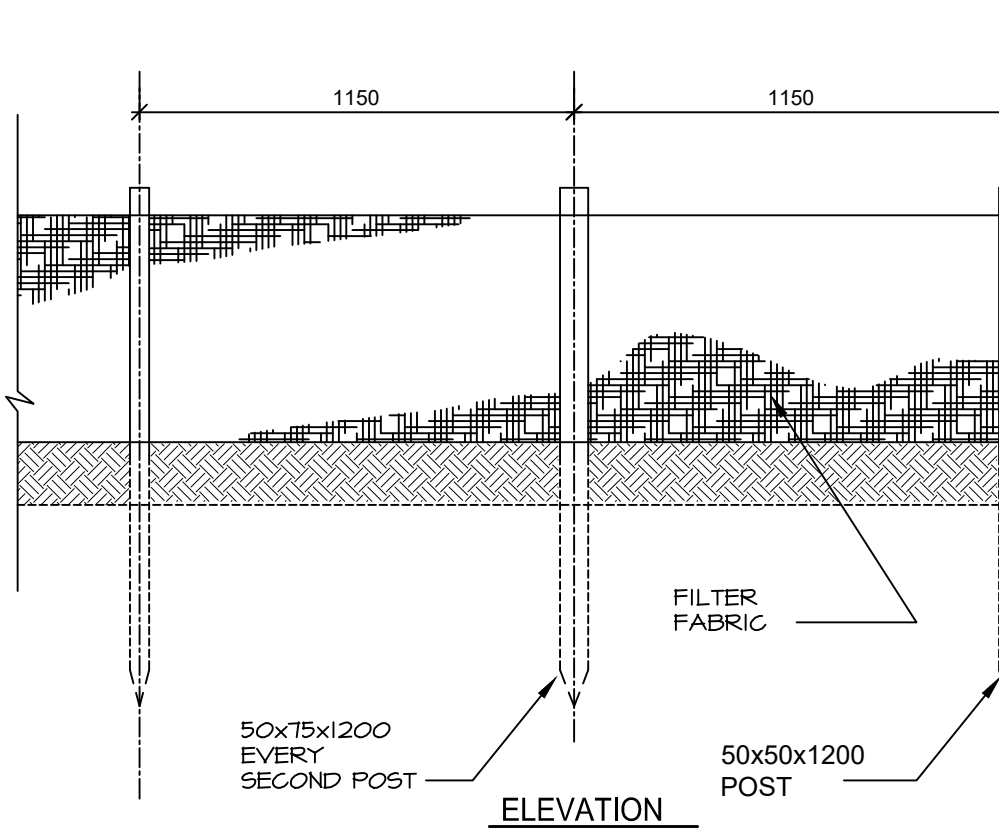

6 SILT FENCE DETAIL
C100 C105 1:20

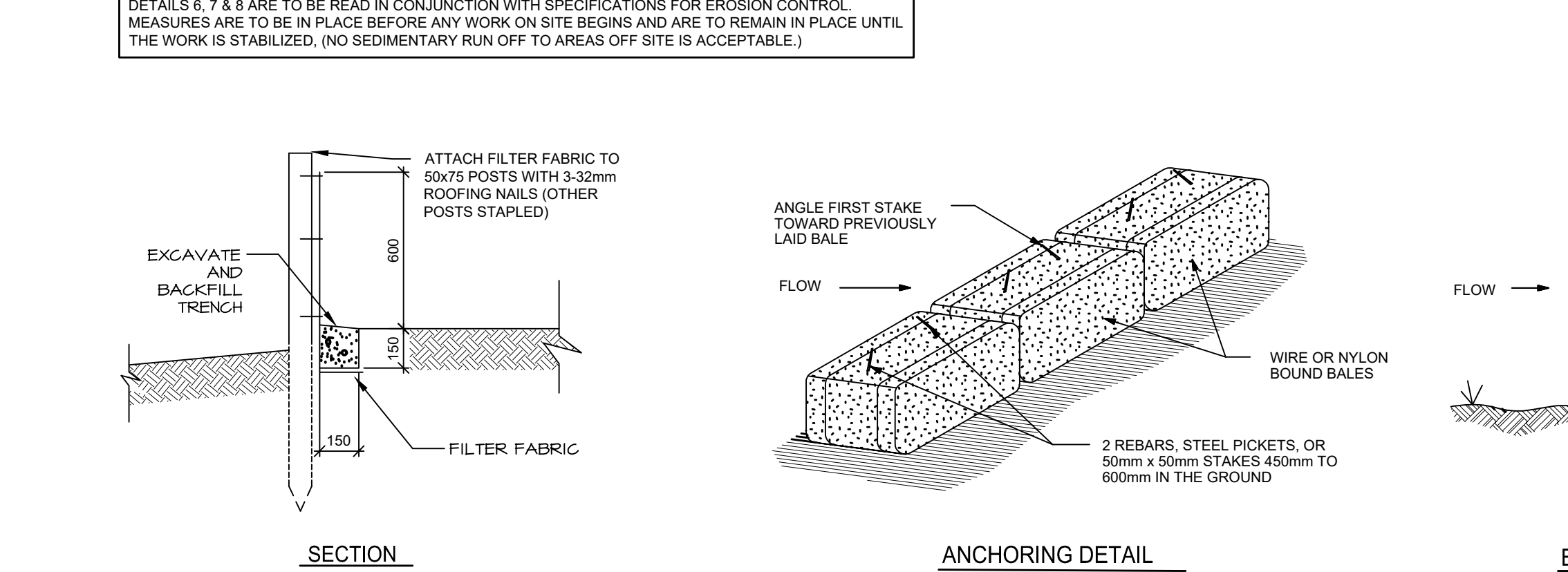

7 SILT FENCE DETAIL
C100 C105 1:20

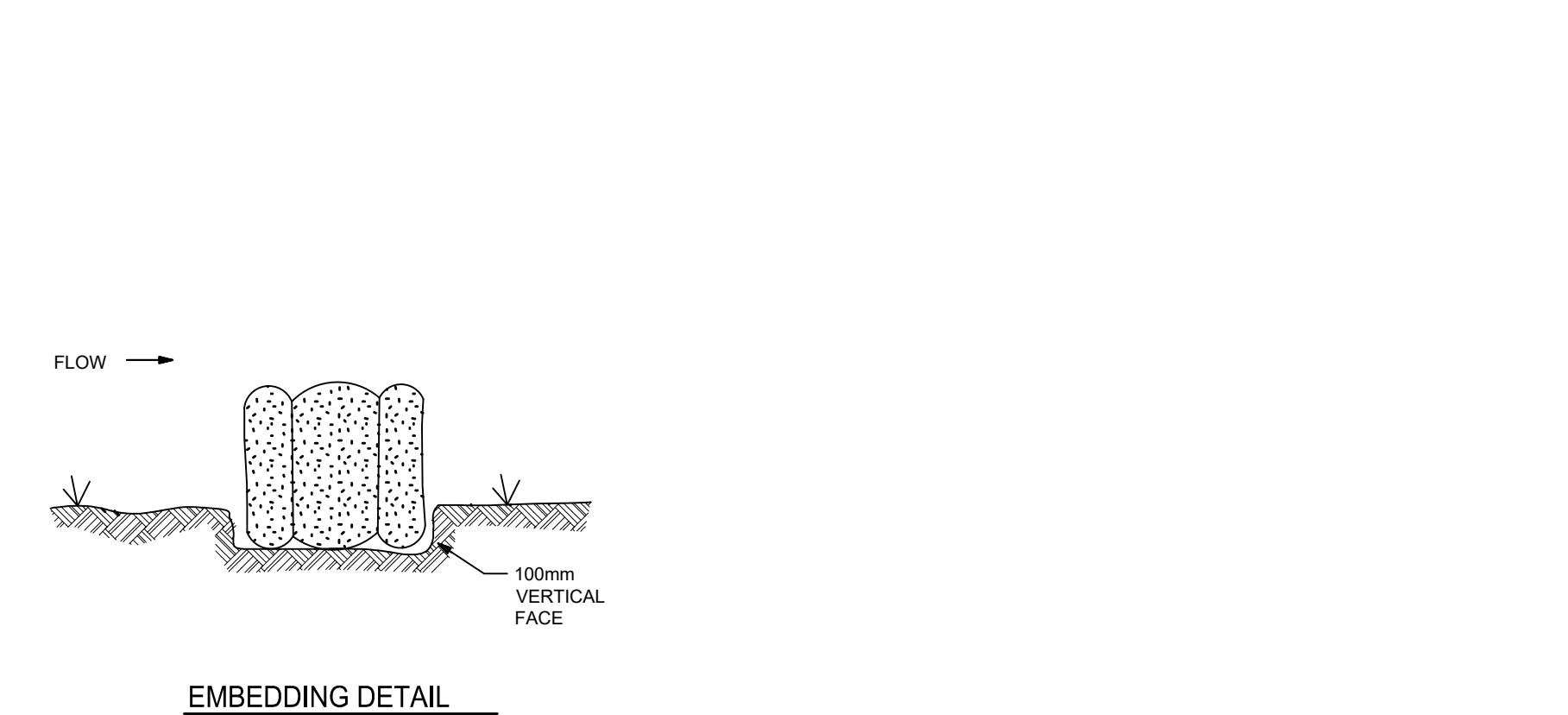

8 EROSION CONTROL BERM
C100 C105 1:20

- GENERAL NOTES:**
- CONTRACTOR MUST VISIT THE SITE AND BE FAMILIAR WITH EXISTING CONDITIONS.
 - VERIFY ALL DIMENSIONS AND REPORT ANY DISCREPANCIES TO THE CONSULTANT BEFORE PROCEEDING WITH THE WORK.
 - ALL DIMENSIONS AND ELEVATIONS ARE IN METRIC UNITS U.N.O.
 - THESE DRAWINGS SHALL BE VIEWED IN CONJUNCTION WITH THE CONTRACT DOCUMENTS AND SPECIFICATIONS.
 - PRIOR TO COMMENCING WORK, THE CONTRACTOR SHALL VERIFY THE EXACT LOCATION AND ELEVATIONS OF ALL EXISTING UTILITIES AND SERVICES (SHOWN OR NOT SHOWN ON DRAWINGS) IN THE FIELD WITHIN THE CONTRACT LIMIT. INFORMATION SHOWN ON PLANS IS APPROXIMATE ONLY.
 - UNDERGROUND WATER, SEWER, FUEL OIL, TELEPHONE, POWER SERVICES EXIST BENEATH THE SITE. EXERCISE CAUTION IN EXCAVATION AND PROTECT FACILITIES FROM DAMAGE. CONTRACTOR TO REPAIR DAMAGES AT NO COST TO THE OWNER. WORK SHALL BE CARRIED OUT TO THE SATISFACTION OF THESE AUTHORITIES. CONTACT UTILITIES BEFORE EXCAVATING.
 - PRIOR TO COMMENCING WORK, COORDINATE AND OBTAIN APPROVAL FROM THE PROJECT MANAGER FOR CONNECTING TO EXISTING WATER & SEWER SERVICES.
 - PROVIDE TEMPORARY SUPPORT TO EXISTING STRUCTURES AND UTILITY POLES AS REQUIRED.
 - THE WORK SHALL BE IN ACCORDANCE WITH THE NATIONAL BUILDING CODE OF CANADA 2015, APPLICABLE LAWS AND STANDARDS.
 - PERFORM WORK AND COMPLY WITH ALL FEDERAL, PROVINCIAL AND MUNICIPAL BY-LAWS AND REGULATIONS.
 - THE CONTRACTOR WILL BE REQUIRED TO MAINTAIN TRAFFIC AND ACCESS TO THE SITE AT ALL TIMES DURING THIS CONTRACT AND ACCESS FOR EMERGENCY VEHICLES ON CONSTRUCTION SITE. PROVIDE SIGNS, BARRICADES, FLAGGERS AS PER APPLICABLE REGULATIONS.
 - ALL TRENCHES WITHIN CITY RIGHT OF WAYS MUST BE BACKFILLED AT THE END OF EACH DAY.
 - REPAIR & REINSTATE DISTURBED ASPHALT PAVEMENT, GRASSED & LANDSCAPED AREAS, SIGNS, RETAINING WALLS, ETC. DAMAGED BY WORK OF CONTRACT INCLUDING ALL AREAS IMPACTED BEYOND LIMIT OF CONTRACT.
- ENVIRONMENTAL PROTECTION NOTES:**
- INSTALLATION OF ENVIRONMENTAL CONTROLS SHALL BE A FIRST STEP IN THE CONSTRUCTION SEQUENCE. THEIR DESIGN, INSTALLATION AND MAINTENANCE SHALL BE AS PER PEI DOT&PW'S ENVIRONMENTAL PROTECTION PLAN, SECTION 7.0 AND PROJECT SPECIFICATIONS.
 - CONSTRUCT AND INSTALL AT TOP OF SLOPE AROUND PERIMETER OF ALL TEMPORARY AND PERMANENT CONSTRUCTION AREAS INCLUDING AROUND STOCKPILES OF FILL SILT FENCES & EROSION CONTROL DEVICES. ALL ENVIRONMENTAL CONTROLS (E.G. SILT FENCING, CHECK DAMS, SEDIMENT COLLECTION PONDS, ETC.) SHALL BE IN PLACE PRIOR TO, DURING AND AFTER PROJECT ACTIVITIES TO AVOID OFFSITE SILTATION.
 - ENSURE THAT ALL SILT FENCES ARE IN PLACE AND MAINTAINED ON A DAILY BASIS TO PREVENT SEDIMENTS FROM THE WORK AREAS FROM ENTERING ANY WATER COURSE OR CATCH BASINS. MAINTAIN FENCE AT ALL TIMES AND REPLACE IF DAMAGED. REMOVE ACCUMULATED SEDIMENTS TO PREVENT BLOCKAGE OF FENCES AND DAMS OR AS DIRECTED BY CONSULTANT. REMOVE AND REPLACE EROSION CONTROL STRUCTURES WHEN THEY BECOME CLOGGED WITH SOIL PARTICLES OR AS DIRECTED BY ENGINEER REPAIR ALL DAMAGES CAUSED BY SOIL EROSION OR CONSTRUCTION ACTIVITIES AT OR BEFORE THE END OF EACH WORKING DAY.
 - INSTALL SEDIMENT COLLECTION POND AT END OF THE OUTFALL & AT THE END OF THE DITCHES TO FILTER SEDIMENT FROM SURFACE RUNOFF BEFORE IT IS DISCHARGED TO WATERCOURSE.
 - ENSURE THAT RUNOFF IS DIRECTED THROUGH SEDIMENT COLLECTION PONDS.
 - DO NOT DISTURB EXISTING VEGETATION ANY MORE THAN NECESSARY TO COMPLETE EACH PHASE OF THE PROJECT.
 - INSTALL A LAYER OF MULCH OR AN EROSION CONTROL BLANKET TO ALL EXPOSED SLOPES THAT IS NOT IMMEDIATELY UNDER CONSTRUCTION APPLIED AND MAINTAINED UNTIL THE AREA IS READY TO BE COMPLETED, SHARPED AND STABILIZED WITH SEEDING, SOO OR RIP-RAP.
 - APPLY GRAVEL TO THE ROADWAY BED AS SOON AS POSSIBLE.
 - SEED/SOD ALL EXPOSED AND BARREN SOIL AS SOON AS POSSIBLE.
 - THIS PROJECT MUST COMPLY WITH THE REQUIREMENTS OF THE PEI DEPARTMENT OF ENVIRONMENT CERTIFICATE OF APPROVAL, CITY OF CHARLOTTETOWN UTILITY SERVICE AGREEMENT AND OTHER APPLICABLE PERMITS.
 - ALL WORK TO BE PERFORMED IN ACCORDANCE WITH PEI OCCUPATIONAL HEALTH & SAFETY ACT, FEDERAL, PROVINCIAL & MUNICIPAL BY-LAWS & REGULATIONS.
 - ENVIRONMENTAL PROTECTION MEASURES SHALL BE CARRIED OUT TO THE SATISFACTION OF THE CONSULTANT & AUTHORITIES HAVING JURISDICTION AND THE COST OF ALL THESE DEVICES & MEASURES SHALL BE INCLUDED IN THE CONTRACT PRICE.
 - REPORT ANY DOUBTFUL CONDITIONS REQUIRING DECISIONS & SECURE DIRECTIONS FROM THE CONSULTANT BEFORE PROCEEDING WITH THE WORK.
 - THE CONTRACTOR IS TO HAVE ON HAND, THE APPROPRIATE EMERGENCY RESPONSE PHONE NUMBERS AND CONTACTS TO ALERT THE APPROPRIATE AUTHORITIES OF POSSIBLE CONTAMINATION SHOULD A SPILL OCCUR.

DETAILS 6, 7 & 8 ARE TO BE READ IN CONJUNCTION WITH SPECIFICATIONS FOR EROSION CONTROL MEASURES ARE TO BE IN PLACE BEFORE ANY WORK ON SITE BEGINS AND ARE TO REMAIN IN PLACE UNTIL THE WORK IS STABILIZED. (NO SEDIMENTARY RUN OFF TO AREAS OFF SITE IS ACCEPTABLE.)

No.	Description	Date	Date:	Revision
0	Issued for Tender	2021-10-07	October 2021	0
			Drn By: SPM, EIT	
			Chk By: N.L. P.Eng	
			Project Number:	
			211120	
			Drawing Number:	
			C1-103	

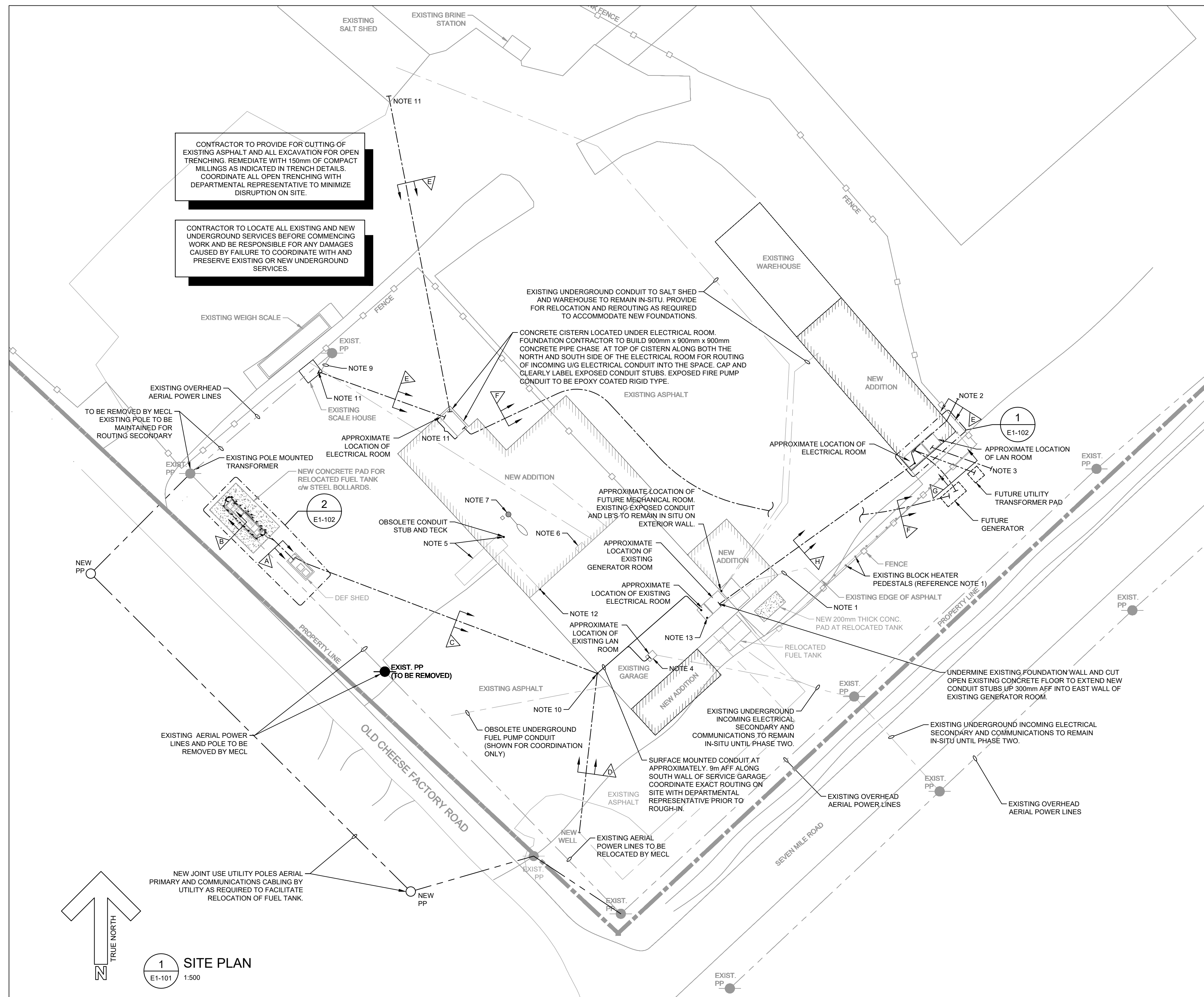

1 SITE PLAN
E1-101 1:500

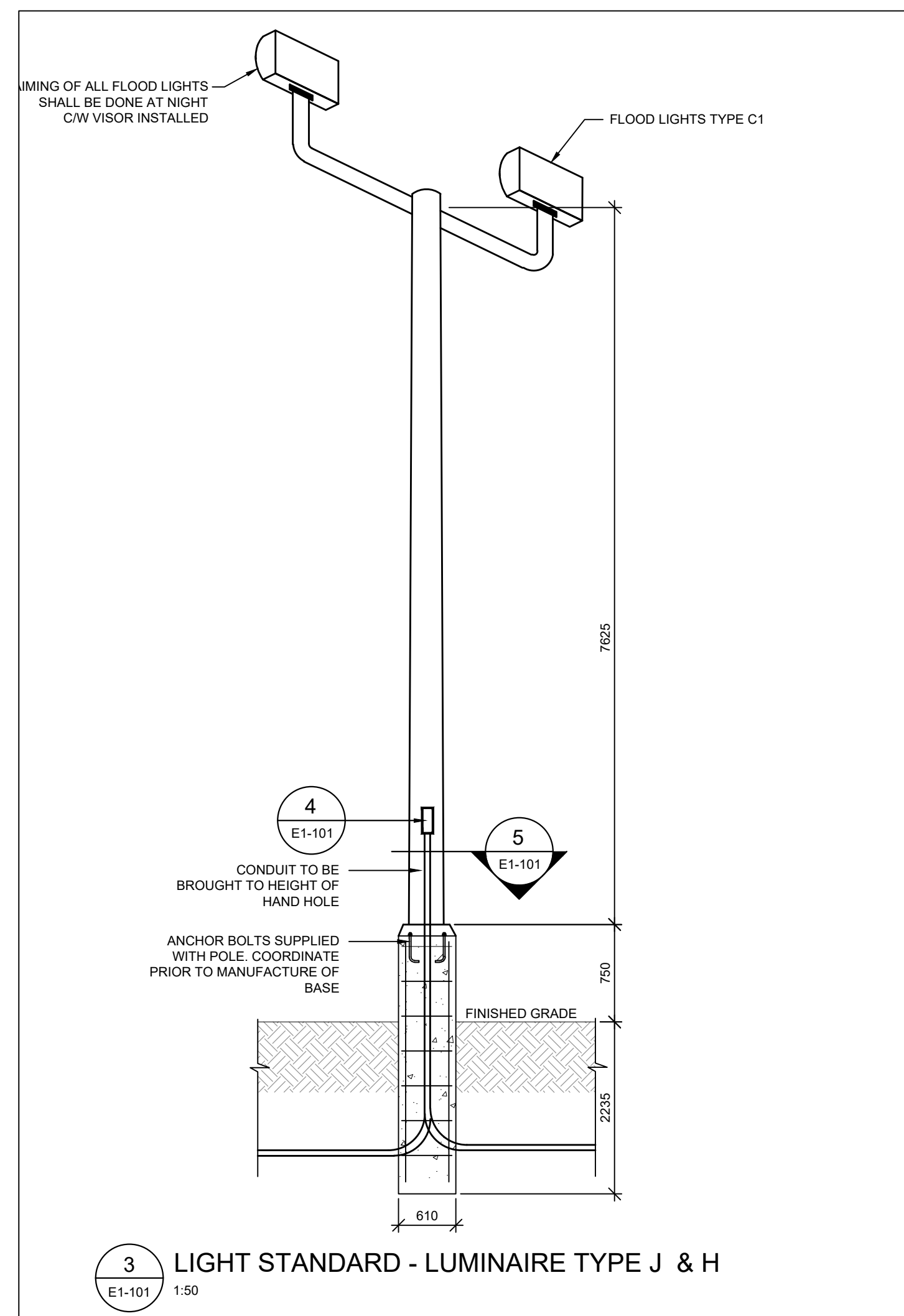

3 LIGHT STANDARD - LUMINAIRE TYPE J & H
E1-101 1:50

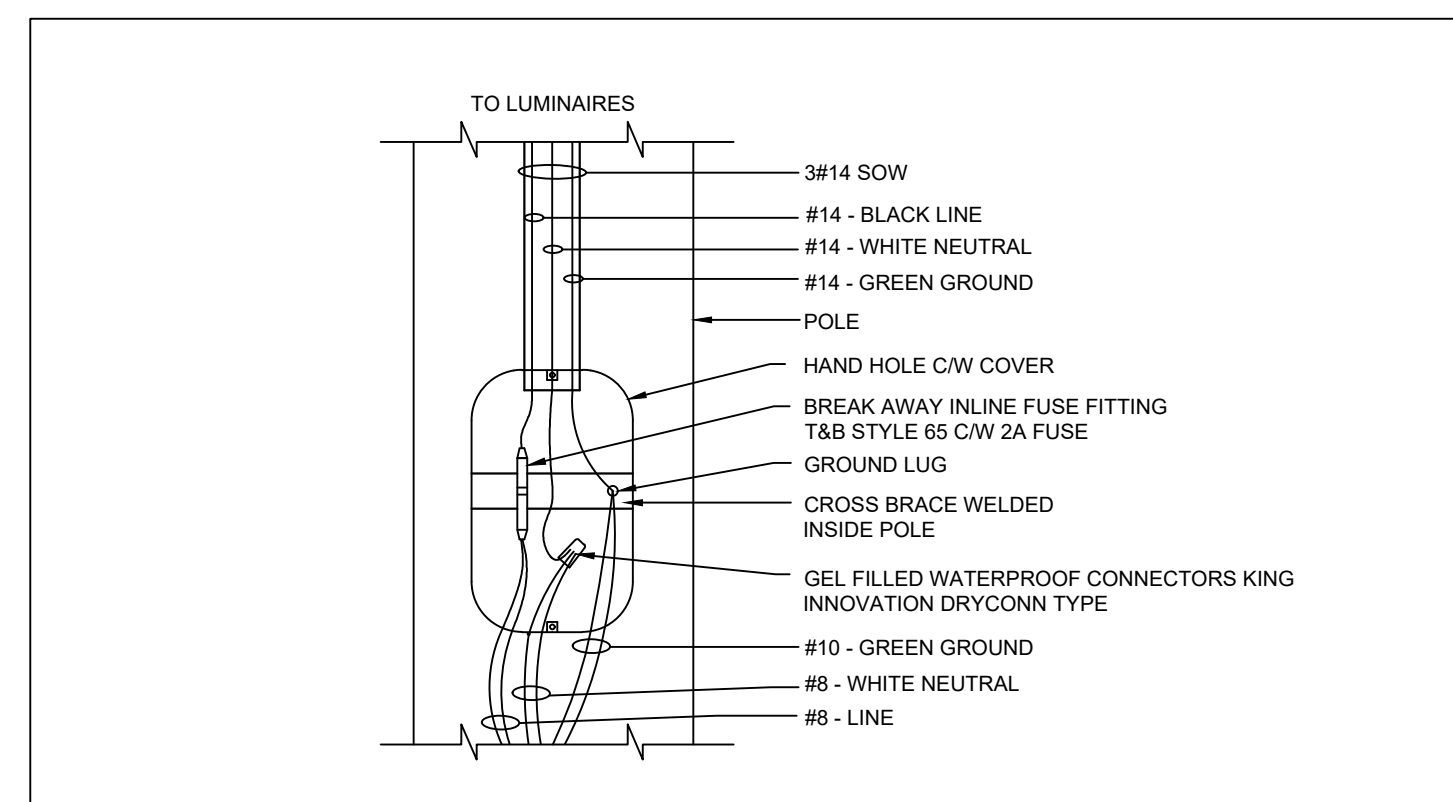

4 SITE LIGHTING - POLE HAND HOLE
E1-101 NTS

ELECTRICAL LEGEND	
(Symbol)	INDICATES FIRE RATED WALL
(Symbol)	REFER TO ARCHITECTURAL DRAWINGS FOR SPECIFIC LOCATIONS AND CONSTRUCTION INFORMATION
(Symbol)	LIGHT LINEWEIGHT INDICATES EXISTING TO REMAIN
(Symbol)	HEAVY LINEWEIGHT INDICATES NEW WORK
(Symbol)	AERIAL SERVICE LINES
(Symbol)	UNDERGROUND WIRING
(Symbol)	SURFACE MOUNTED WIRING
(Symbol)	CONCEALED WIRING, SLASHES INDICATE NUMBER OF CONDUCTORS
(Symbol)	WIRING UP
(Symbol)	WIRING DOWN
(Symbol)	CONDUIT STUB
(Symbol)	INDICATES 2#12 DC WIRING
(Symbol)	GROUND ROD
(Symbol)	EXISTING LIGHT STANDARD C/W CONCRETE BASE
(Symbol)	LUMINAIRE, POLE MOUNTED # - INDICATES TYPE IN LUMINAIRE SCHEDULE
(Symbol)	LUMINAIRE, CEILING MOUNTED # - INDICATES TYPE IN LUMINAIRE SCHEDULE
(Symbol)	LUMINAIRE, WALL MOUNTED # - INDICATES TYPE IN LUMINAIRE SCHEDULE
(Symbol)	EXISTING UTILITY POLE
(Symbol)	DUPLEX RECEPTACLE
(Symbol)	DIRECT CONNECTION
(Symbol)	ELECTRICAL PANEL, SURFACE MOUNTED 'A' - INDICATES PANEL DESIGNATION
(Symbol)	UTILITY SERVICE POLE

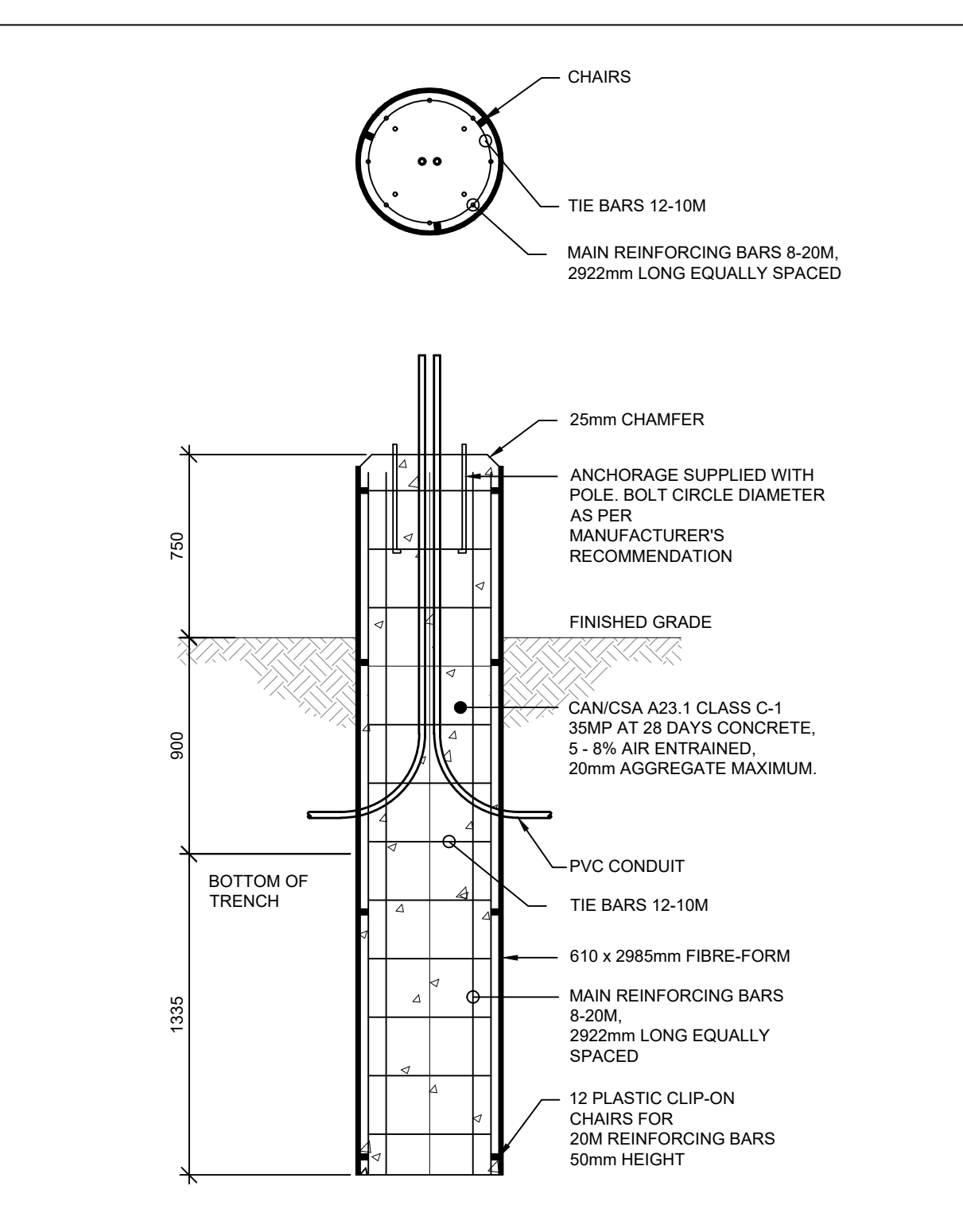

5 SITE LIGHTING BASE
E1-101 NTS

GENERAL NOTES

- ANY NEW OR OBSOLETE AND CUT BACK CONDUIT THAT IS CAPPED AND LEFT BURIED UNDERGROUND IS TO BE CLEARLY LABELED AND SWING THE INFORMATION FOR CONDUIT STUB LOCATION PROVIDED TO FACILITATE FUTURE LOCATIONS. INFORMATION TO BE PROVIDED IN MAINTENANCE MANUALS AS A ROUGH SKETCH.

- NOTES**
- TRACE OUT, DISCONNECT AND REROUTE AND EXTEND EXISTING BLOCK HEATER BRANCH CIRCUIT WIRING AS REQUIRED TO ACCOMMODATE NEW FOUNDATION. INSTALL NEW BLOCK HEATER BRANCH CIRCUIT WIRING UP SOUTH EXTERIOR FACADE AND THROUGH MECHANICAL ROOM TO RECONNECT TWELVE (12) BLOCK 20A HEATERS RECEPTACLES.
 - CAP PVC CONDUIT IN GROUND AND MARK LOCATION WITH WOODEN STAKE AND RECORD SWING TIE LOCATION. CONDUIT TO BE USED FOR FUTURE EV SCHOOL BUS CHARGERS.
 - CAP PVC CONDUIT IN GROUND AND MARK LOCATION WITH WOODEN STAKE AND RECORD SWING TIE LOCATION. CONDUIT TO BE USED FOR FUTURE INCOMING COMMUNICATIONS SERVICE CONDUIT.
 - COIL 3m WORTH OF GREEN JACKETED CAT5 CABLE AT EXISTING DATA RACK AND TERMINATE WITH RJ45 MODULE. CONNECTION AND PROGRAMMING OF FUEL SYSTEM ON NETWORK TO COMPLETED BY ITSS.
 - TRACE OUT, DISCONNECT AND REMOVE ALL EXISTING ELECTRICAL ASSOCIATED WITH EXISTING FUEL TANK BACK TO SOURCE. ANY UNDERGROUND OBSOLETE WIRING NOT IMPACTED OR EXCAVATED DURING CONSTRUCTION IS TO BE CUT BACK BELOW GRADE AND CLEARLY LABELED AS OBSOLETE.
 - EXISTING WASTE OIL TANK TO BE RELOCATED. TRACE OUT, SPLICE AND EXTEND EXISTING BRANCH CIRCUIT TO WASTE OIL ALARM AND PUMP WITH 2#12, 1#14 BOND IN 21mmc. EXACT LOCATION TO BE DETERMINED ON SITE. PROVIDE FOR 15m WORTH OF EXTENSION.
 - TRACE OUT, DISCONNECT AND REMOVE ALL EXISTING ELECTRICAL ASSOCIATED WITH EXISTING LIGHT STANDARD AND ADJACENT POST MOUNTED BRANCH CIRCUIT PANEL. BOARD BACK TO SOURCE. ANY UNDERGROUND OBSOLETE WIRING NOT IMPACTED OR EXCAVATED DURING CONSTRUCTION IS TO BE CUT BACK BELOW GRADE AND CLEARLY LABELED AS OBSOLETE.
 - EXISTING SALT STORAGE UNDERGROUND ELECTRICAL IS TO BE LOCATED, TRACE OUT, SPLICED AND EXCAVATED AROUND NEW FOUNDATION AS REQUIRED TO MAINTAIN CIRCUIT. USE INLINE WEATHER TIGHT BUTT END SPLICE AS REQUIRED.
 - EXISTING OVERHEAD TRIPLEX TO EXISTING SCALE HOUSE MAST AND 60A, 240V SERVICE. COORDINATE AND PROVIDE FOR ALL COSTS ASSOCIATED WITH RELOCATING EXISTING POWER AND COMMUNICATIONS SERVICES TO SCALE HOUSE.
 - ROUTE CONDUIT UP BUILDING FACADE APPROXIMATELY 3m AFG AND THEN THROUGH EXTERIOR WALL THROUGH SIDEWALL OF MAINTENANCE BUILDING. COORDINATE EXACT ROUTING ON SITE WITH DEPARTMENTAL REPRESENTATIVE. SEAL EXTERIOR PENETRATIONS WITH LOW VOC MASTIC COMPOUND AND SERVICE GROUND PENETRATIONS WITH FIRE SEALING. PROVIDE FOR MECHANICAL PROTECTION AROUND BASE OF CONDUIT RISER AND LINEAR EXPANSION SLEEVES.
 - CAP AND CLEARLY LABEL PVC CONDUIT AT 600mm AFG AGAINST EXTERIOR SIDE OF FOUNDATION WALL FOR FUTURE USE.
 - TRACE OUT, DISCONNECT AND REMOVE ALL ELECTRICAL ASSOCIATED WITH EXISTING VSMART MODULE AND INTRINSICALLY SAFE CABINET. RELOCATE TO NEW DEF SHED ELECTRICAL CLOSE.
 - TRACE OUT, DISCONNECT AND REMOVE ALL ELECTRICAL ASSOCIATED WITH EXISTING DIESEL AND GAS PUMP RELAYS AND E-STOP CONTACTOR. RELOCATE PUMP RELAYS AND E-STOP CONTACTOR TO NEW DEF SHED ELECTRICAL CLOSE. EXISTING FUEL PUMP 60A, 120/240V, 10, 12 CIRCUIT SQUARE-D PANELBOARD TO BE DISCONNECTED AND TURNED OVER TO OWNER. EXISTING 60A/2P BRANCH CIRCUIT BREAKER LOCATED IN ADJACENT PANELBOARD TO BE MAINTAINED AND USED TO CONNECT NEW LARGER FUEL PANELBOARD 'FP' AT DEF SHED.

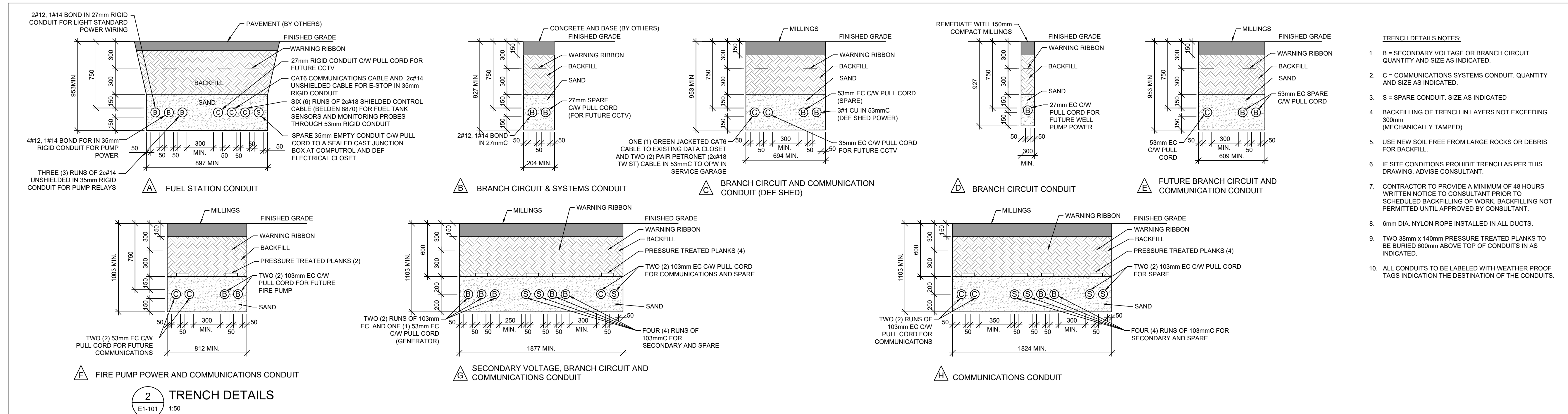

2 TRENCH DETAILS
E1-101 1:50

No.	Description	Date	Date:	Revision
	Issued for Addendum	2021-10-20	2021-10-20	
			Drn By: M.E.M., C.E.T.	
			Chk By: E.S.C., P.ENG	
			Project Number:	
			211120	
			Drawing Number:	
			E1-101	

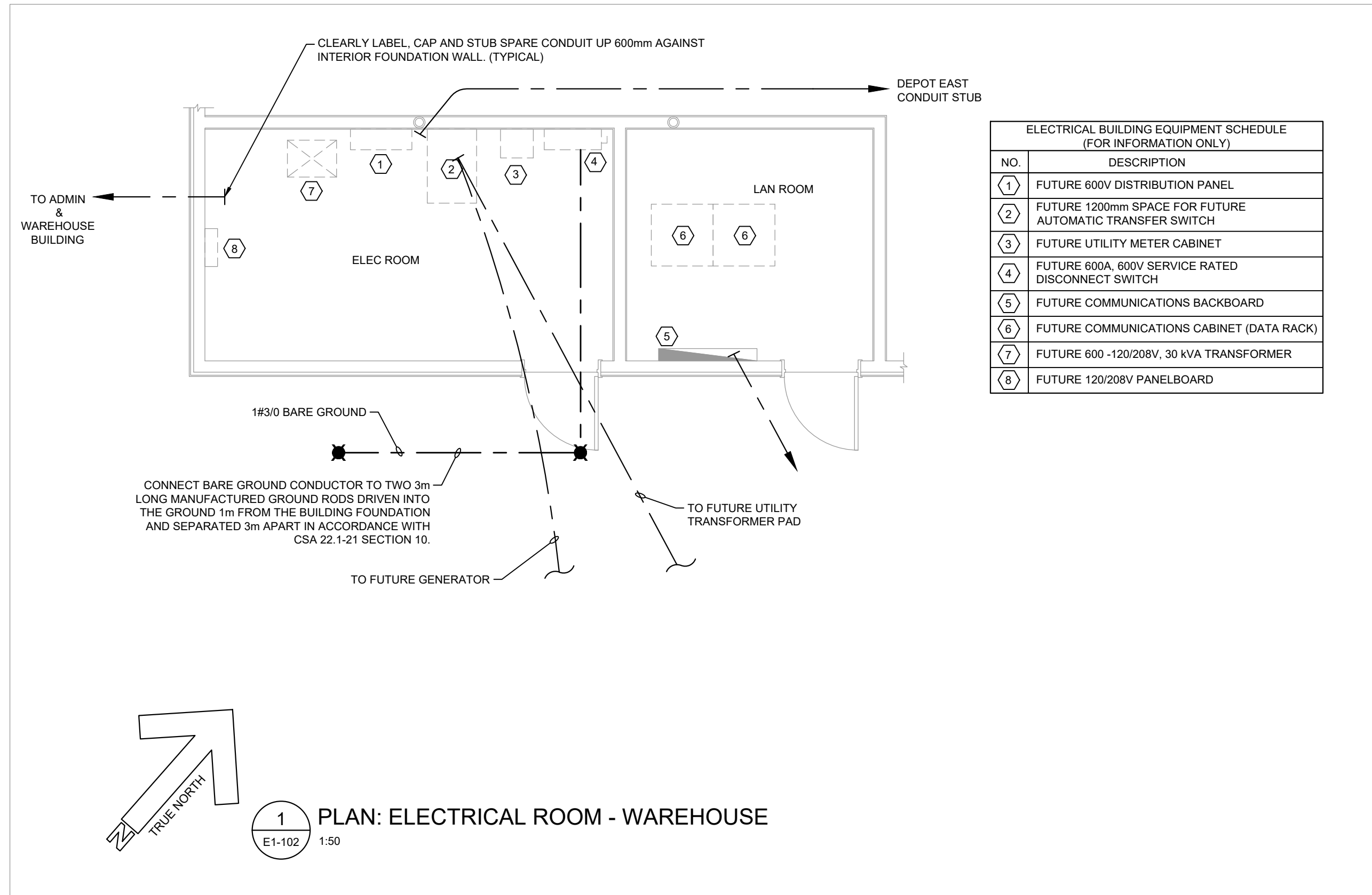

ELECTRICAL BUILDING EQUIPMENT SCHEDULE
(FOR INFORMATION ONLY)

NO.	DESCRIPTION
1	FUTURE 600V DISTRIBUTION PANEL
2	FUTURE 1200mm SPACE FOR FUTURE AUTOMATIC TRANSFER SWITCH
3	FUTURE UTILITY METER CABINET
4	FUTURE 600A 800V SERVICE RATED DISCONNECT SWITCH
5	FUTURE COMMUNICATIONS BACKBOARD
6	FUTURE COMMUNICATIONS CABINET (DATA RACK)
7	FUTURE 600 - 120/208V, 30 kVA TRANSFORMER
8	FUTURE 120/208V PANELBOARD

PANEL 'A'

DESIGNATION	LOAD		P	BKR	CIRCUIT				BKR	P	LOAD		DESIGNATION	
	A	B			1	2	3	4			A	B		
LIGHTING	750	2000	1	15	1	A	2	20	2		1000		DEF PUMP	
DEF SHED HEATERS			2	30	3	B	4				1000		DEF PUMP	
COMPU POWER		120	1	15	7	B	8	20	2		1000		DIESEL PUMP	
PUMP HEAD		120	1	15	9	A	10				1000		GASOLINE PUMP	
RECEPTACLE		120	1	15	11	B	12	20	2		1000		GASOLINE PUMP	
SPACE			1		13	A	14		1					
SPACE			1		15	B	16		1					
SPACE			1		17	A	18		1					
PHASE LOADS:	2870	2240								3000	3000			
TOTAL PHASE LOADS:	5870	5240								SUPPLY: 120/240V, 1Ø, 3w				
TOTAL LOADS:	11110										MAINS: 60 MB - BOTTOM FED (1Ø KAIC)			
											NUMBER OF CIRCUITS: 18			
CURRENT AT 208V/3PH:	53										MOUNTING: SURFACE			

(*) INDICATES LOCKING BREAKER

LUMINAIRE SCHEDULE

TYPE	DESCRIPTION	SOURCE	MOUNTING
A1	609mm LONG, LED STRIP FIXTURE. CW FROSTED ACRYLIC ROUND DIFFUSED LENS AND GENERAL DISTRIBUTION, WHITE FINISH, 120V DRIVER. LITHONIA #CLX L24 1500LM SEF RDL MVOLT GZ10 40K 80CRI WH PHILIPS #SS220L840-LNV-DIM ORACLE LIGHTING #Z-OC1-2000L-DIM 1Ø-MVOLT-40K-85	LED 1500 LUMENS 11W L70@100,000h CRI 80 4000K	COORDINATE EXACT LOCATION AND MOUNTING HEIGHT WITH GENERAL CONTRACTOR ON SITE.
B1	146mm (w) x 171mm (h) x 82mm (d) LONG. EXTERIOR LED WALL PACK, CW IMPACT-RESISTANT TEMPERED GLASS AND BLACK POWDER COAT FINISH, 120V DRIVER. LITHONIA #DLWX1 LED 13W 40K DDB LUMARK #XTOR1B-W-BK PHILIPS #LPW7-8-BZ STANDARD #LWPSLM32/12W40/120-277/BRZ1STD	LED 1300 LUMENS 12W L89@72,000h CRI 10 4000K	WALL MOUNTED ON THE EXTERIOR FACADE OF THE BUILDING AT 2800mm AFG. COORDINATE EXACT LOCATION AND MOUNTING HEIGHT WITH GENERAL CONTRACTOR ON SITE PRIOR TO ROUGH-IN.
C1	326mm (w) x 189mm (h) x 80mm (d), EXTERIOR POLE MOUNTED LED FLOOD LIGHT, WIDE FLOOD DISTRIBUTION, GASKETED DIE-CAST ALUMINUM HOUSING CW BLACK POWDER COAT FINISH AND VISOR SHIELD 120V DRIVER, POLE TO BE SQUARE STEEL CW BLACK POWDER COAT FINISH, 7.62m HEIGHT, MINIMUM EPA RATING OF 4 SQFT AT 80 MPH. INSTALL TENON MOUNTED CROSS ARM WHEN TWO (2) LUMINAIRES ARE MOUNTED ON A SINGLE POLE. LITHONIA #DSX3 LED 6 PI WFL MVOLT IS UVB DBLXD + #SSQL6-2S-BLACK LUMARK #FFLD-A40-E-UNV-66-S-BK-TS2NFFLD-xx + VALMONT #DS330-2S-P2-FP-BK-FBC-AB PHILIPS #FL150-NW-G1-K-FL-8-BZ CW VISOR SHIELDS + ALUMINOUS #SSQL6-2S-BLACK CREE #OSQ-ANMMEK40KULB+OSQ-AA-BK CW VISOR SHIELDS + DYNA POLE #SS56-DB-2S-BK	LED 129 W L80 @ 100,000h 4000 LUMEN CRI 70 4000K	LED FLOOD TO BE BULLHORN MOUNTED AT 7.625 METERS ABOVE FINISHED GRADE. COORDINATE EXACT INSTALLATION AND MOUNTING HEIGHT ON SITE PRIOR TO ROUGH-IN.

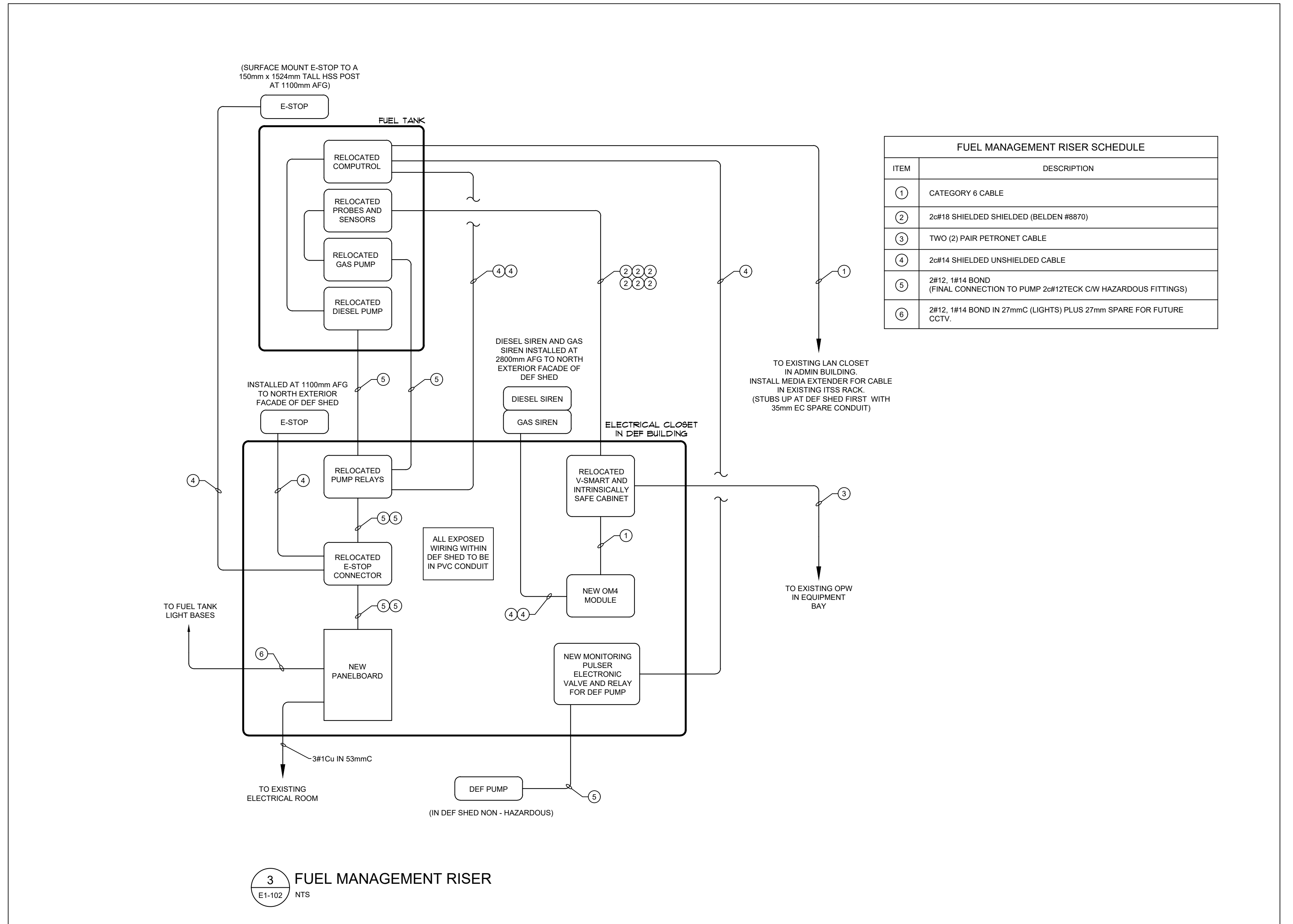
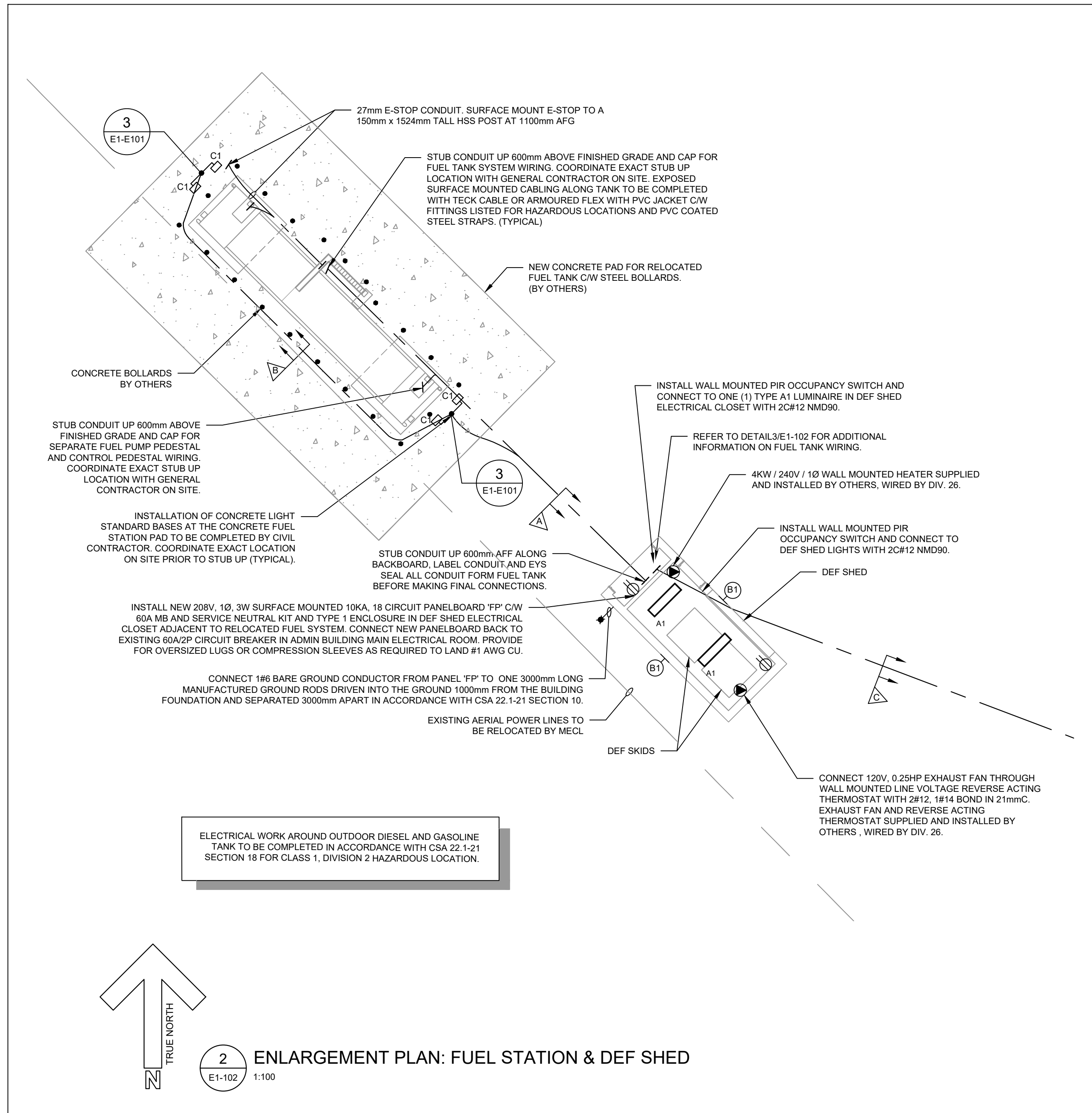

FUEL MANAGEMENT RISER SCHEDULE

ITEM	DESCRIPTION
1	CATEGORY 6 CABLE
2	2x#18 SHIELDED SHIELDED (BELDEN #8870)
3	TWO (2) PAIR PETRONET CABLE
4	2x#14 SHIELDED UNSHIELDED CABLE
5	2#12, 1#14 BOND (FINAL CONNECTION TO PUMP 2x#12TECK CW HAZARDOUS FITTINGS)
6	2#12, 1#14 BOND IN 27mmC (LIGHTS) PLUS 27mm SPARE FOR FUTURE CCTV.